



PRODUCT YOU CAN TRUST

# TIMBER FRAME CONNECTORS

## ST-PFS

Timber Frame Holding Down Strap

Engineered solution to restrain timber structures against uplift when using timber joists, engineered joists or concrete ground floors. Suitable for 50 - 100mm cavities. Stainless steel fixing pack of 150 nails available separately - suitable for one bundle of straps.

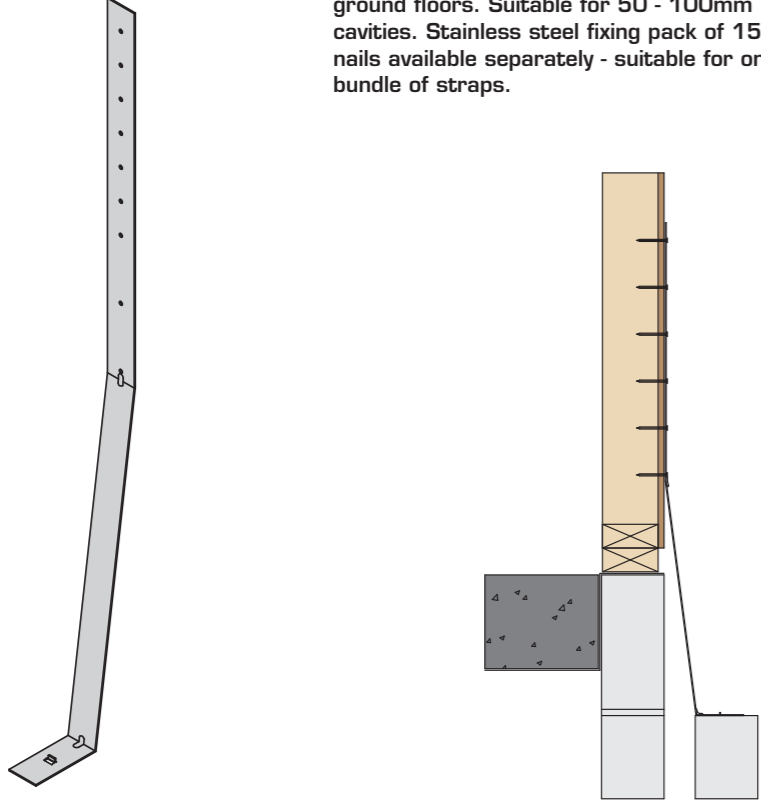

## ST-PFS-M

Timber Frame Holding Down Strap

Mini version of the ST-PFS, suitable for 50 - 100mm cavities. Stainless steel fixing pack of 100 nails to suit available separately - suitable for 1 bundle of straps.

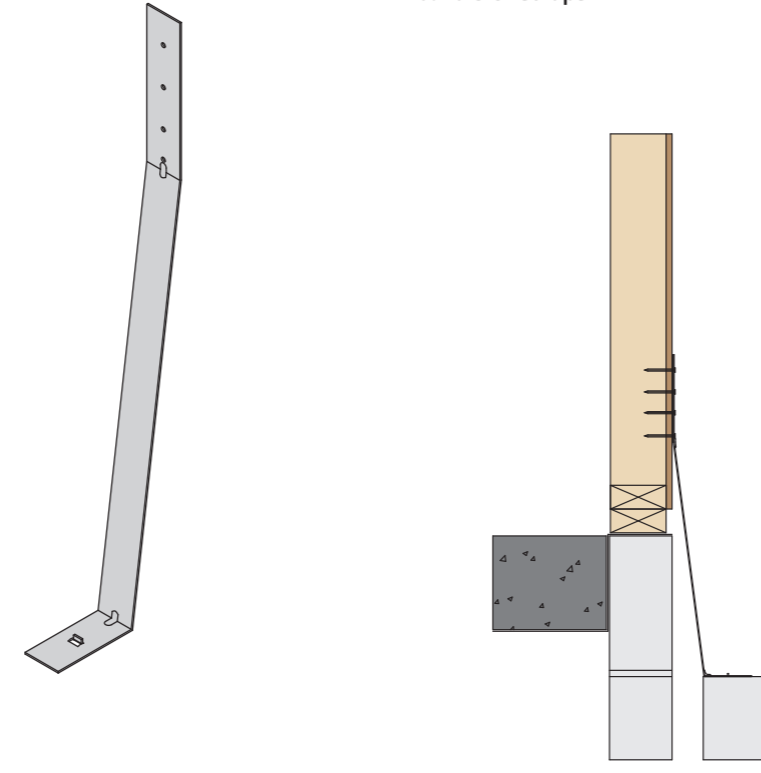

## SP-90

Sole Plate Anchor

The SP-90 is designed to locate and anchor timber sole plates.

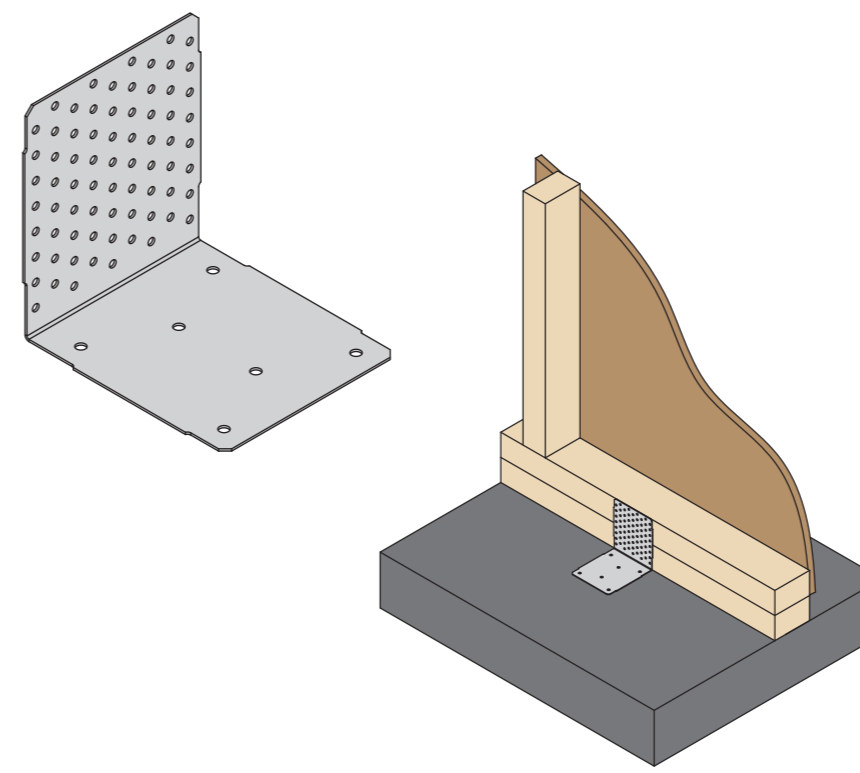

## SP-138

Sole Plate Anchor

The SP-138 locates and anchors timber sole plates where it is necessary to provide more fixings to the base material.

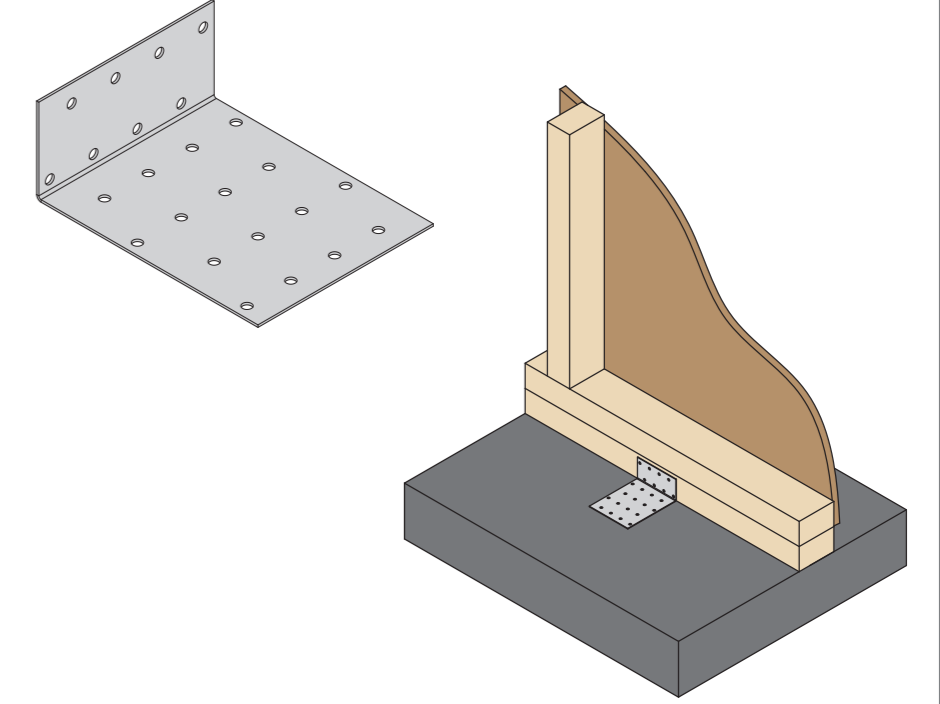

## SP-240

Sole Plate Anchor

The SP-240 locates and anchors timber sole plates where it is necessary to provide the maximum number of fixings to the base material.

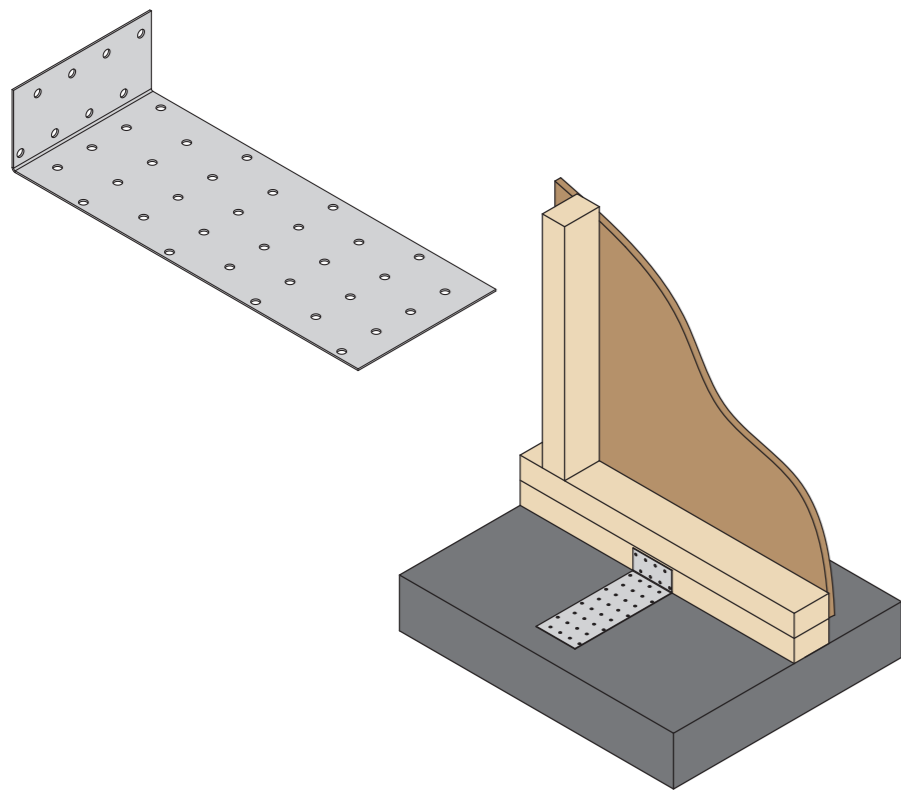

## IR-CLIP

Insulation Retaining Clip

Allows for the use of high performance rigid insulation whilst maintaining a service gap.

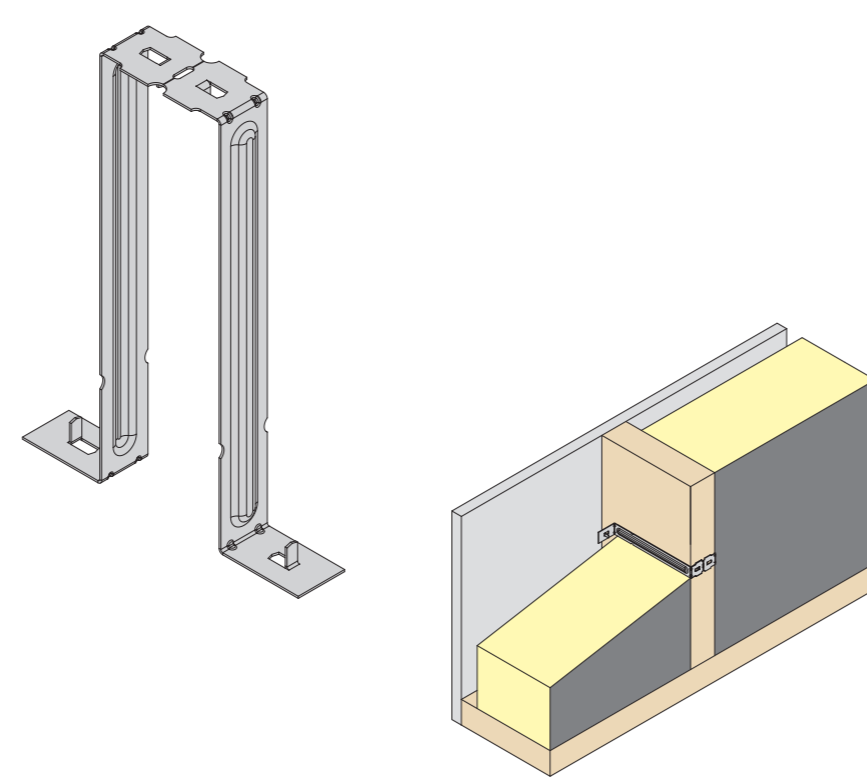

## PWS

Party Wall Strap

Connects separating walls in attached dwellings.

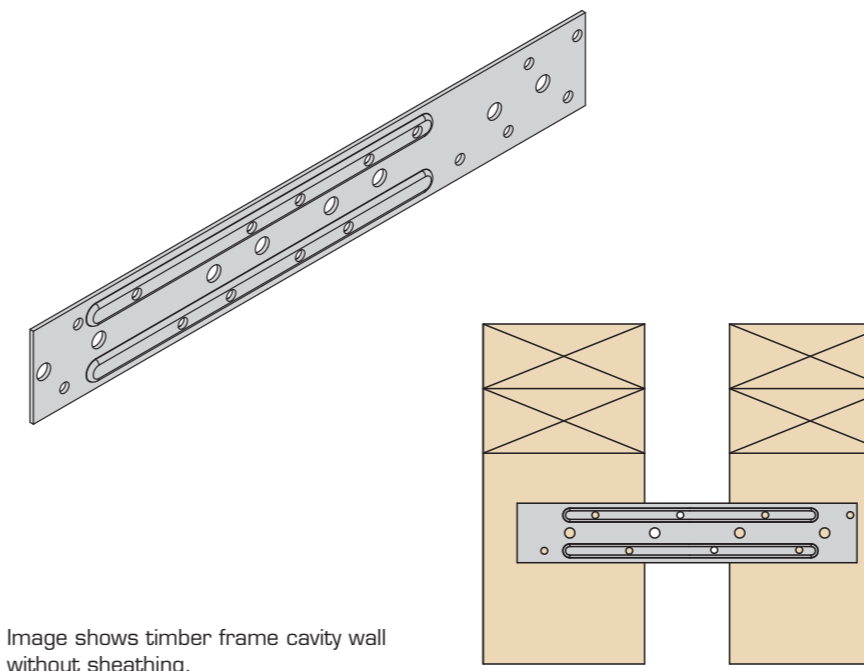

## AWS

Acoustic Wall Strap

Connects separating walls in attached dwellings with superior strength and acoustic properties.

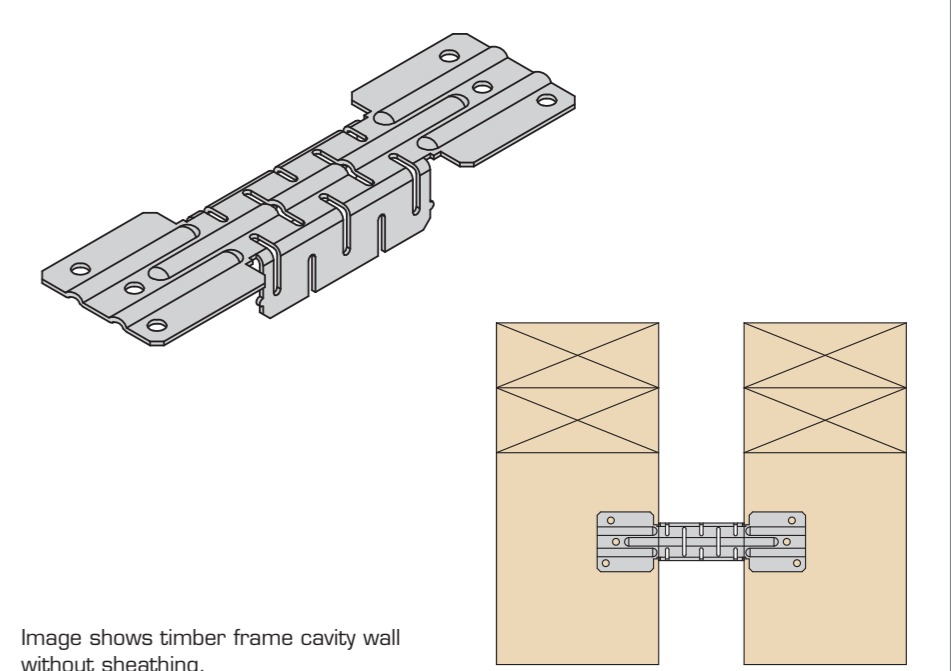

## FT

Timber Frame / SIPs Wall Tie

Restrains the external blockwork/brickwork back to the timber frame structure.

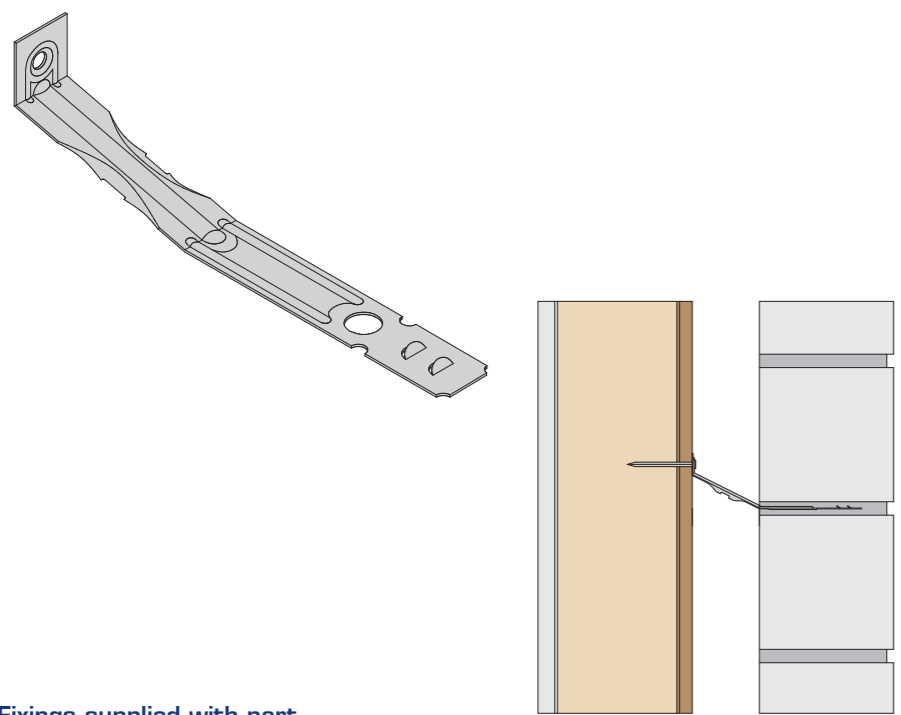

Fixings supplied with part  
3.35 x 50mm stainless steel annular ring shank nails



## HMT

High Movement Timber Frame Wall Tie

Restrains the external blockwork/brickwork back to the timber frame structure. Provides greater performance to accommodate differential movement in medium to high rise structures.

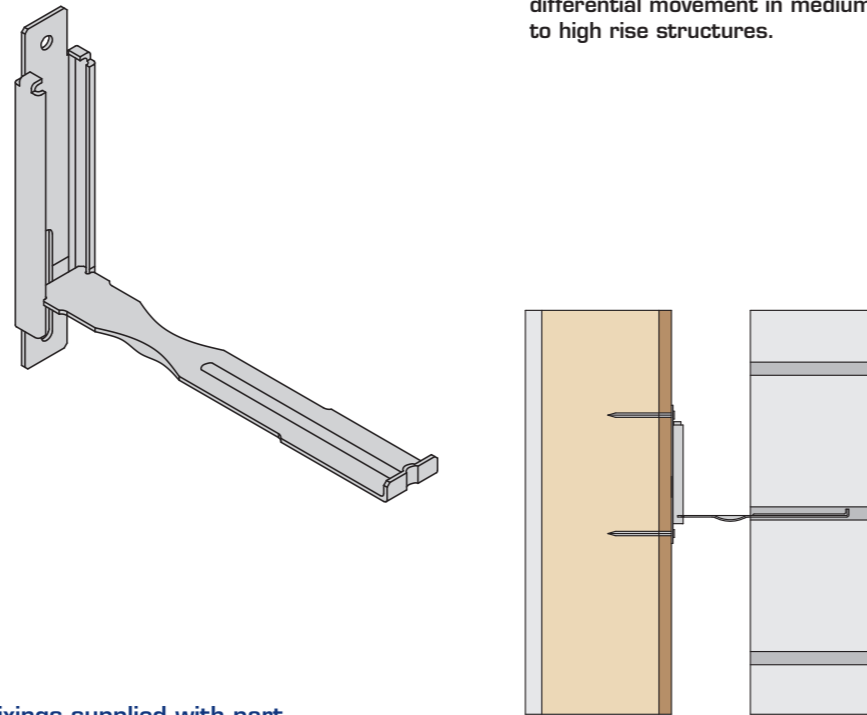

Fixings supplied with part  
3.35 x 50mm stainless steel annular ring shank nails



## RD-DCR

Disproportionate Collapse Restraint

Permits timber separating floors to comply with the sound insulation requirements and comply with disproportionate collapse requirements.

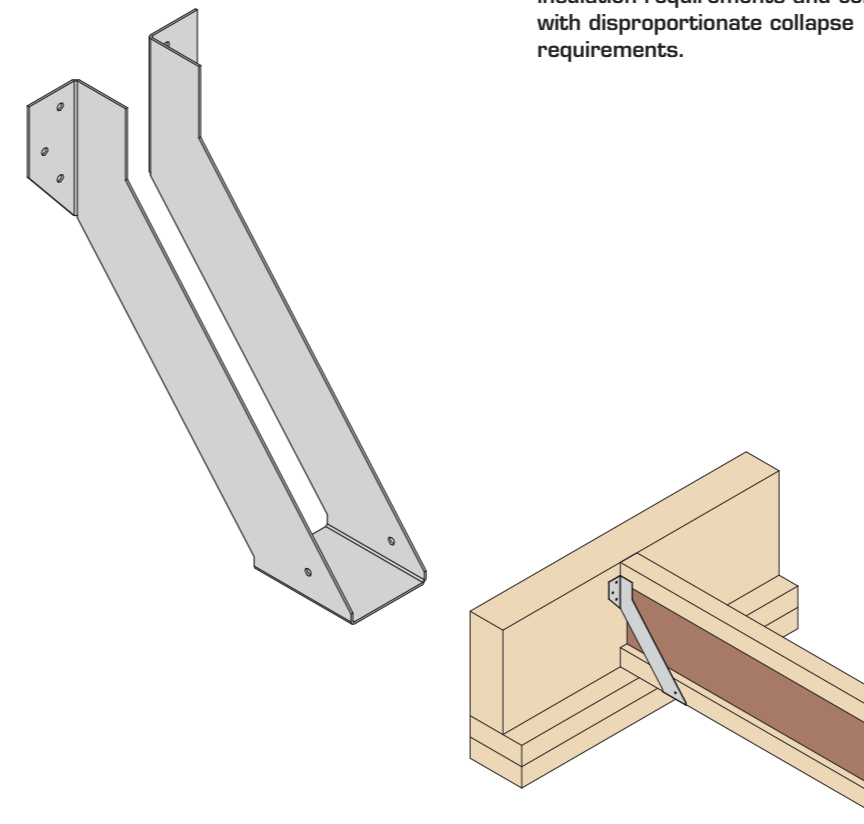

## RD-HDCR

Heavy Disproportionate Collapse Restraint

High load disproportionate collapse restraint for supporting internal beams onto the rim beam.

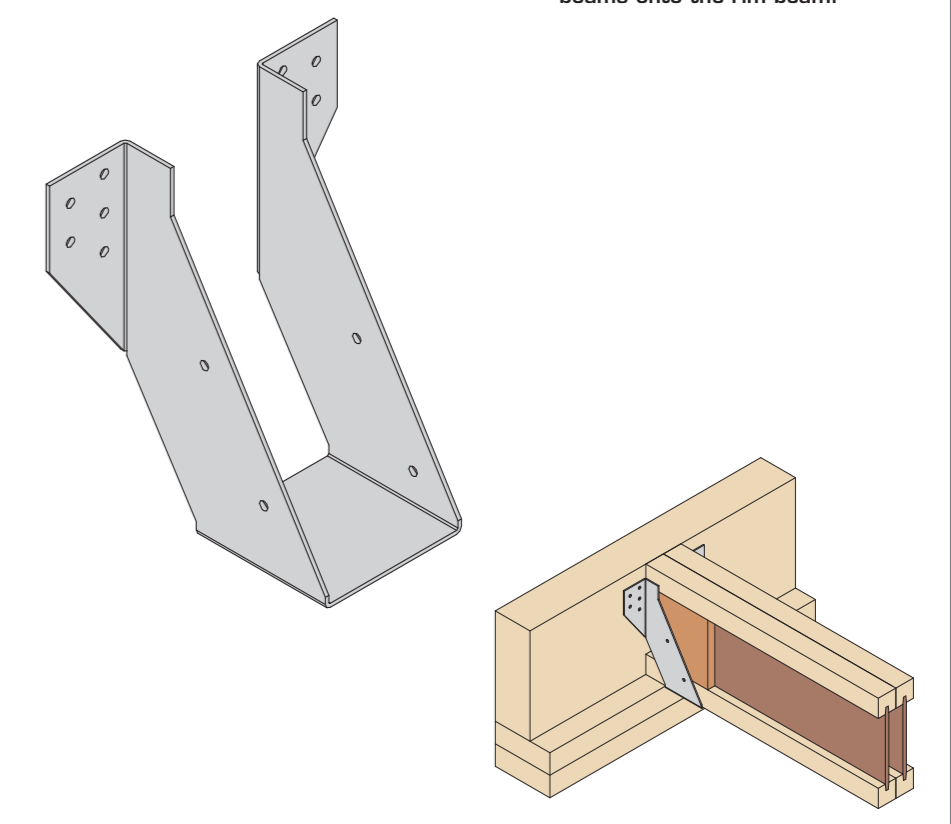

## RD-CDCR

Corner Disproportionate Collapse Restraint

High load disproportionate collapse detail for connecting rim beams at corner junctions.

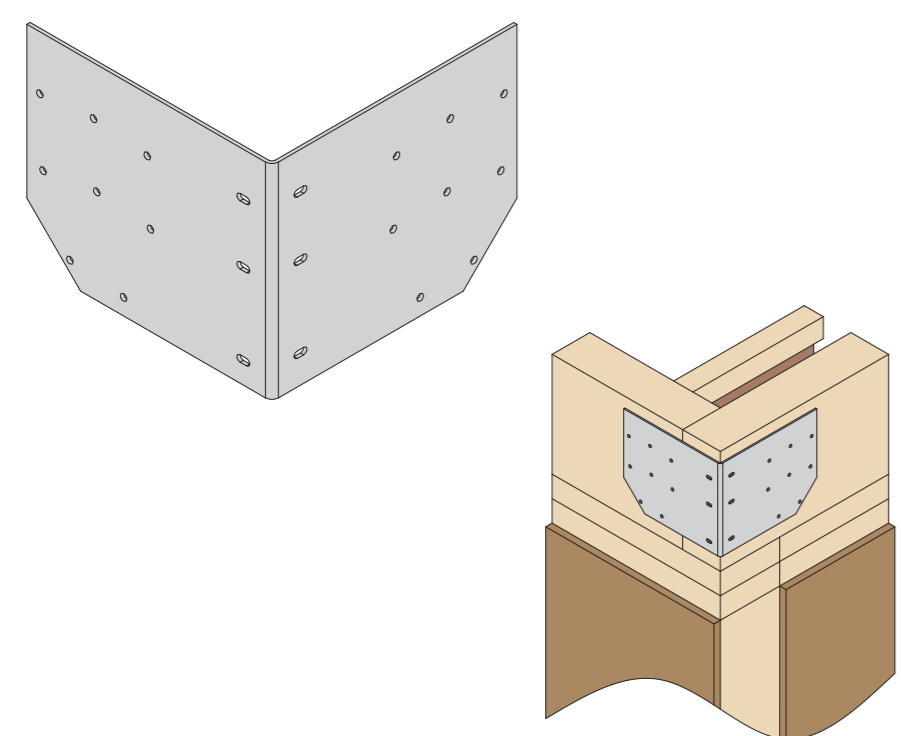

### DOWNLOAD CULLEN APP



## PPN35Ci

Cordless Positive Placement Nailer

Makes light work of driving ETA approved, CE compliant hardened twist nails through hangers, connector plates and strapping - four times faster than a hammer.



## NAIL PACK

Square Twist Hardened Nails  
Positive placement nails, for use with Paslode PPN35Ci.



Shank Type:	Square Twist Hardened
Shank Diameter:	3.4mm
Length:	25mm
Head Diameter:	7.0mm
Average Profile Diameter:	3.7mm
Finish:	12µm Electro Galv



## LOOSE NAILS

3.4 x 35mm Electrogalvanised Square Twist Nails  
Connectors have been tested with these nails.



Shank Diameter:	3.4mm
Length:	35mm
Head Diameter:	8.0mm
Average Profile Diameter:	3.7mm
Finish:	12µm Electro Galv

## PSTS

Structural Timber Screws

Requires no pre-drilling, quick and easy to install.



Outer Thread Shank Diameter:	6.5mm	8.0mm
Plain Shank Diameter:	4.8mm	5.85mm
Length:	35 - 250mm	65 - 135mm
Head Diameter:	11.5mm	16mm
Finish:	5µm Electro Galv	5µm Electro Galv

## LOOSE NAILS

3.35 x 50mm Stainless Steel Annular Ring Shank Nails  
Stainless steel connectors have been tested with these nails.



Shank Type:	Ring Shank
Shank Diameter:	3.35mm
Length:	50mm
Head Diameter:	-
Average Profile Diameter:	-
Finish:	Stainless Steel



Cullen Technical Support:  
t : 01592 777570 (option 4)  
e : cullentechnical@itwcp.com

Printed May 2017

Cullen Customer Services:  
t : 01592 771132 (option 1)  
e : orders@itwcp.com

www.itwcp.com